

POINTER KNOBS

Pointer Knobs

PN-1

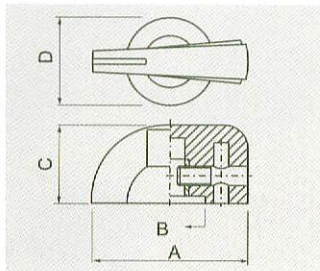

A	B	C	D	SHAFT HOLE	
33.4	∅15.2	17.0	∅19.0	∅6.4	∅6.1

FEATURES:

- Material : Phenolic.
- With white indicator line.
- Set screw on one side.
- With brass insert.

PN-1B

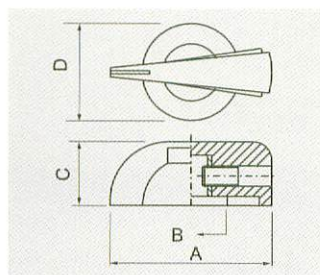

A	B	C	D	SHAFT HOLE	
31.5	∅14.0	12.8	∅19.0	∅6.4	

FEATURES:

- Material : Phenolic.
- With white indicator line.
- Set screw on one side.
- With brass insert.

PN-8

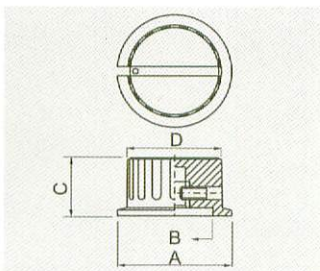

	A	B	C	D	SHAFT HOLE	
C	∅34.8	∅23.3	18.0	∅29.0	∅6.4	∅6.1
D	∅24.0	∅15.0	20.0	∅19.0	∅6.4	∅6.1
E	∅20.3	∅11.7	15.6	∅15.7	∅6.4	∅6.1
F	∅15.5	∅9.5	14.2	∅12.3	∅6.4	∅6.1 ∅3.2
G	∅12.5	∅8.2	12.2	∅10.5	∅3.2	

FEATURES:

- Material : Phenolic.
- With white dot on top.
- Set screw on one side.
- With brass insert.



PN-8G

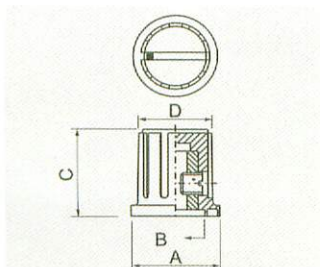

A	B	C	D	SHAFT HOLE	
∅12.5	∅8.2	12.0	∅10.5	∅3.2	

FEATURES:

- Material : Phenolic.
- With white dot on top.
- Set screw on one side.
- With brass insert.

PN-9

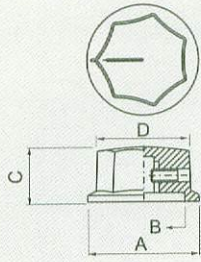

	A	B	C	D	SHAFT HOLE	
C	∅33.5	∅23.4	17.5	∅27.2	∅6.4	
D	∅28.0	∅23.0	15.7	∅23.6	∅6.4	∅6.1
E	∅23.8	∅13.8	15.0	∅18.5	∅6.4	18 tooth
F	∅19.2	∅11.7	12.3	∅15.0	∅6.4	∅3.2 18 tooth

FEATURES:

- Material : Phenolic.
- With white indicator line & white dot.
- Set screw on one side.
- With brass insert.



PN-24

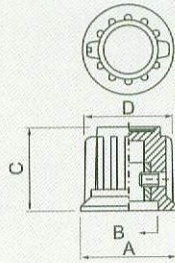

	A	B	C	D	SHAFT HOLE	
	∅20.0	∅12.8	17.0	∅18.6	∅6.4	D hole

FEATURES:

- Material : Phenolic.
- With white indicator line.
- Set screw on one side.
- With brass insert.
- With aluminum spun inlay.

PN-26

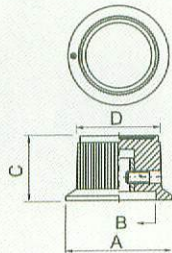

	A	B	C	D	SHAFT HOLE	
A	∅32.0	∅28.5	17.8	∅26.5	∅6.4	
B	∅24.8	∅24.6	15.0	∅18.5	∅6.4	∅6.1

FEATURES:

- Material : Phenolic.
- With white dot.
- Set screw on one side.
- With brass insert.
- With aluminum spun inlay.



PN-27

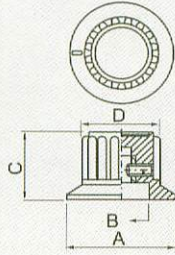

A	B	C	D	SHAFT HOLE
Ø35.0	Ø18.0	21.8	Ø24.6	Ø6.4

FEATURES:

- Material : Phenolic.
- With white indicator line.
- Set screw on one side.
- With brass insert.
- With aluminum spun inlay.

PN-31B1

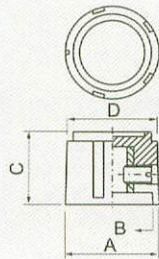

A	B	C	D	SHAFT HOLE
Ø20.5	Ø16.5	16.0	Ø19.0	Ø6.4

FEATURES:

- Material : Phenolic.
- Set screw on one side.
- With brass insert.
- With aluminum spun inlay.

PN-31B2

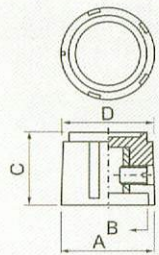

A	B	C	D	SHAFT HOLE
Ø19.8	Ø16.5	15.8	Ø19.0	D hole

FEATURES:

- Material : Phenolic.
- With white indicator line.
- Set screw on one side.
- With brass insert.
- With aluminum spun inlay.

PN-32

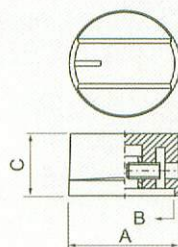

A	B	C	SHAFT HOLE
Ø26.6	Ø24.0	15.4	Ø6.4 D hole

FEATURES:

- Material : Phenolic.
- With white indicator line.
- Set screw on one side.
- With brass insert.
- With aluminum spun inlay.

PN-33A

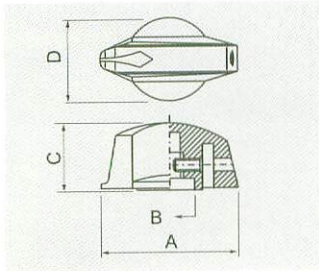

A	B	C	D	SHAFT HOLE	
41.8	Ø14.6	21.3	Ø26.0	Ø6.4	Ø6.1

FEATURES:

- Material : Phenolic.
- With white indicator line.
- Set screw on one side.
- With brass insert.

PN-33B

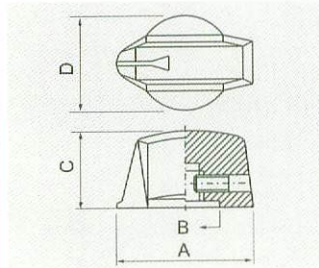

A	B	C	D	SHAFT HOLE	
31.5	Ø16.0	18.2	Ø22.0	Ø6.4	Ø6.1

FEATURES:

- Material : Phenolic.
- With white indicator line.
- Set screw on one side.
- With brass insert.

PN-33C

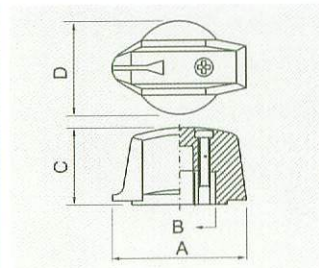

A	B	C	D	SHAFT HOLE	
32.0	Ø22.4	18.4	Ø22.5	Ø6.1	

FEATURES:

- Material : Phenolic.
- With white indicator line.
- Set screw on one side.
- With brass insert.

PN-35

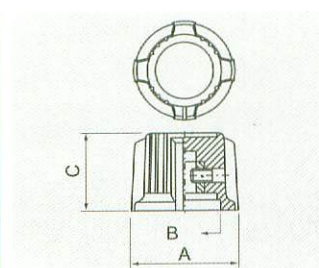

A	B	C	D	SHAFT HOLE	
Ø29.8	Ø17.7	22.2	Ø29.0	Ø6.4	Ø6.1

FEATURES:

- Material : Phenolic.
- With white indicator line.
- Set screw on one side.
- With brass insert.

PN-36

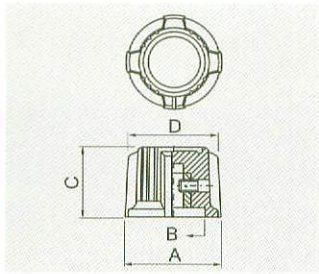

A	B	C	D	SHAFT HOLE
Ø23.0	Ø14.8	19.0	Ø22.4	Ø6.4

FEATURES:

- Material : Phenolic.
- With white indicator line.
- Set screw on one side.
- With brass insert.

PN-37

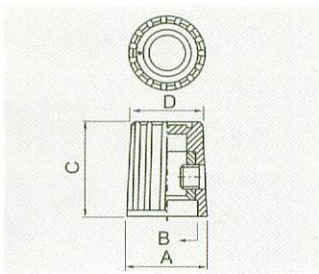

A	B	C	D	SHAFT HOLE
Ø13.0	Ø10.0	15.5	Ø11.8	Ø6.4 Ø6.1

FEATURES:

- Material : Phenolic.
- With white dot.
- Set screw on one side.
- With brass insert.

CONTROL KNOBS

RN-71

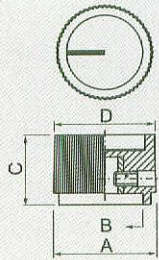

	A	B	C	D	SHAFT HOLE
B	Ø25.4	Ø18.7	17.6	Ø24.6	Ø6.4
C	Ø33.5	Ø26.2	18.6	Ø33.5	Ø6.4

FEATURES:

- Material : Phenolic.
- With indicator line.
- Set screw on one side.
- With brass insert.
- With aluminum spun inlay.



RN-92A

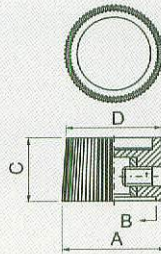

	A	B	C	D	SHAFT HOLE
	Ø20.8	Ø16.8	12.8	Ø18.8	Ø6.4

FEATURES:

- Material : Phenolic.
- Set screw on one side.
- With brass insert.
- With aluminum spun inlay.

RN-92B

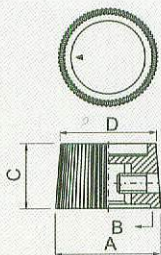

	A	B	C	D	SHAFT HOLE
	Ø20.8	Ø16.8	12.8	Ø18.8	Ø6.4

FEATURES:

- Material : Phenolic.
- With delta mark.
- Set screw on one side.
- With brass insert.
- With aluminum spun inlay.

RN-99

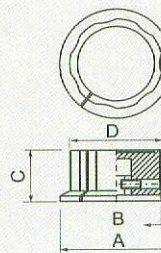

	A	B	C	D	SHAFT HOLE		
A	Ø45.0	Ø37.1	20.3	Ø37.0	Ø6.4	Ø6.1	
C	Ø33.0	Ø26.0	16.0	Ø29.6	Ø6.4	Ø6.1	
D	Ø26.8	Ø22.0	15.8	Ø24.0	Ø6.4	Ø6.1	
E	Ø22.9	Ø14.5	12.7	Ø19.0	Ø6.4	Ø6.1	
F	Ø19.5	Ø12.0	11.5	Ø15.7	Ø6.4	Ø6.1	Ø3.2

FEATURES:

- Material : Phenolic.
- With white indicator line.
- Set screw on one side.
- With brass insert.



RN-100

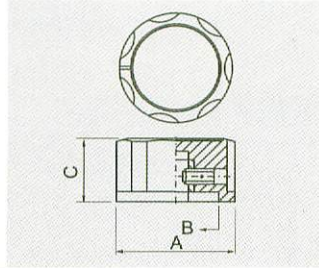

	A	B	C	SHAFT HOLE	
B	∅35.3	∅26.0	16.3	∅6.4	∅6.4
C	∅30.0	∅26.0	16.3	∅6.4	∅6.4
D	∅23.4	∅20.1	15.8	∅6.4	∅6.4
E	∅19.0	∅14.5	13.1	∅6.4	∅6.4
F	∅15.0	∅11.8	11.8	∅6.4	∅6.4

FEATURES:

- Material : ABS
- With white indicator line.
- With color inlay.
- Set screw on one side.
- With brass insert.



RN-110

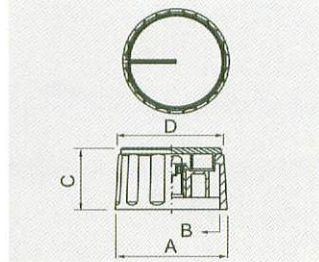

	A	B	C	D	SHAFT HOLE	
C	∅36.5	∅30.0	20.5	∅33.0	∅6.4	∅6.1
D	∅28.5	∅23.0	19.5	∅25.0	∅6.4	∅6.1
E	∅21.3	∅16.0	18.8	∅18.5	∅6.4	∅6.1
F	∅15.3		18.0	∅12.8	∅6.4	∅6.1
G	∅10.0		15.0	∅8.1	∅3.2	

FEATURES:

- Material : ABS
- Indicator line is optional.
- With color inlay.
- Set screw on one top.
- With brass insert.

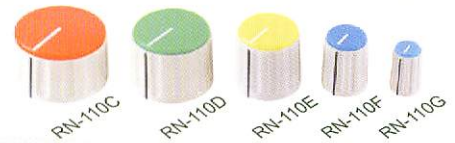

RN-110

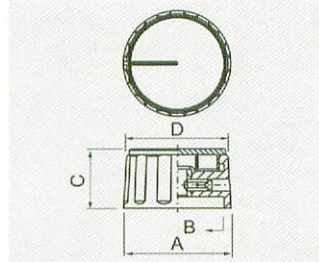

	A	B	C	D	SHAFT HOLE	
CS	∅36.5	∅30.0	20.5	∅33.0	∅6.4	∅6.1
DS	∅28.5	∅23.0	19.5	∅25.0	∅6.4	∅6.1
ES	∅21.3	∅16.0	18.8	∅18.5	∅6.4	∅6.1
FS	∅15.3		18.0	∅12.8	∅6.4	∅6.1
GS	∅10.0		15.0	∅8.1	∅3.2	

FEATURES:

- Material : ABS
- Indicator line is optional.
- With color inlay.
- With one side set screw.
- With brass insert.



RN-110

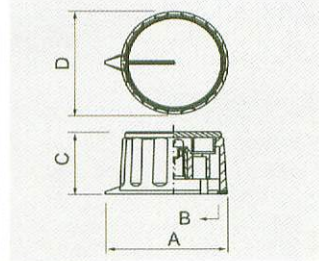

	A	B	C	D	SHAFT HOLE	
CH	41.8	∅30.0	21.8	∅36.7	∅6.4	∅6.1
DH	33.0	∅23.0	21.0	∅28.7	∅6.4	∅6.1
EH	26.0	∅16.0	19.8	∅21.7	∅6.4	∅6.1
FH	18.5		19.2	∅15.6	∅6.4	∅6.1
GH	13.5		15.8	∅10.5	∅3.2	

FEATURES:

- Material : ABS
- Indicator line is optional.
- With color inlay.
- Set screw on one top.
- With brass insert.
- With bottom indicator plate.

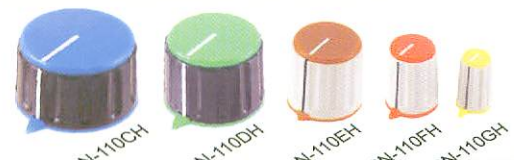

RN-112A

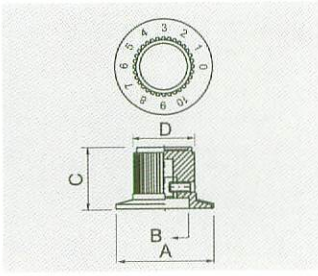

A	B	C	D	SHAFT HOLE
Ø36.8	Ø18.5	23.7	Ø22.7	Ø6.4

FEATURES:

- Material : Phenolic.
- Skirt plate with number 0~10.
- Set screw on one side.
- With brass insert.
- With aluminum spun inlay.

RN-112B

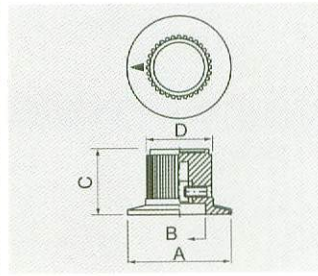

A	B	C	D	SHAFT HOLE
Ø36.8	Ø18.5	23.0	Ø22.7	Ø6.4

FEATURES:

- Material : Phenolic.
- Skirt plate with delta mark.
- Set screw on one side.
- With brass insert.
- With aluminum spun inlay.

RN-113A

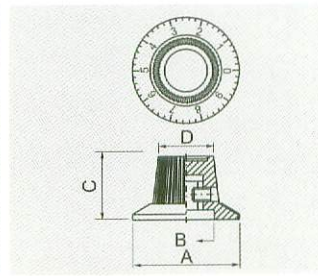

A	B	C	D	SHAFT HOLE
Ø29.2	Ø16.4	18.1	Ø15.0	Ø6.4

FEATURES:

- Material : Phenolic.
- Skirt plate with number 0~9.
- Set screw on one side.
- With brass insert.
- With aluminum spun inlay.

RN-113B

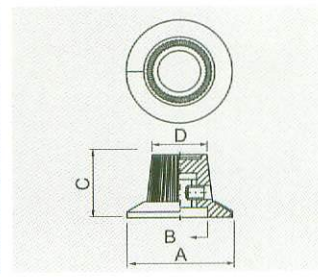

A	B	C	D	SHAFT HOLE
Ø29.2	Ø16.2	17.8	Ø15.0	Ø6.4

FEATURES:

- Material : Phenolic.
- Skirt plate with indicator line.
- Set screw on one side.
- With brass insert.
- With aluminum spun inlay.

RN-114A

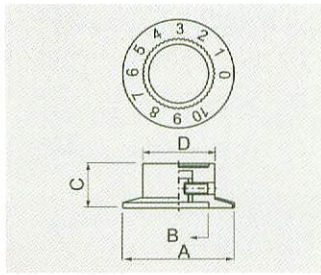

A	B	C	D	SHAFT HOLE
Ø36.8	Ø19.5	14.8	Ø23.8	Ø6.4

FEATURES:

- Material : Phenolic.
- Skirt plate with number 0~10.
- Set screw on one side.
- With brass insert.
- With aluminum spun inlay.

RN-114B

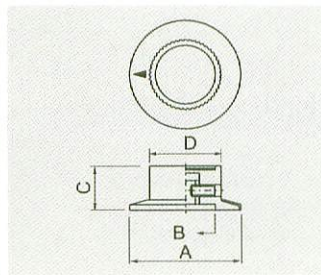

A	B	C	D	SHAFT HOLE
Ø36.8	Ø19.5	15.0	Ø23.8	Ø6.4

FEATURES:

- Material : Phenolic.
- Skirt plate with delta mark.
- Set screw on one side.
- With brass insert.
- With aluminum spun inlay.

RN-117A

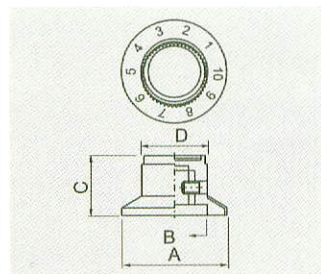

A	B	C	D	SHAFT HOLE
Ø23.6	Ø15.0	14.2	Ø15.2	Ø6.4

FEATURES:

- Material : Phenolic.
- Skirt plate with number 0~10.
- Set screw on one side.
- With brass insert.
- With aluminum spun inlay.

RN-117B

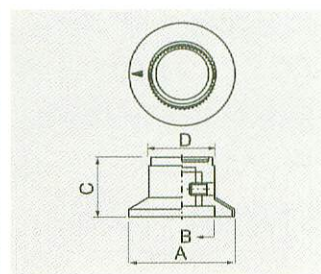

A	B	C	D	SHAFT HOLE
Ø23.6	Ø15.0	14.2	Ø15.2	Ø6.4

FEATURES:

- Material : Phenolic.
- Skirt plate with delta mark.
- Set screw on one side.
- With brass insert.
- With aluminum spun inlay.

RN-118

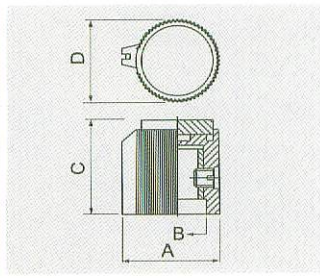
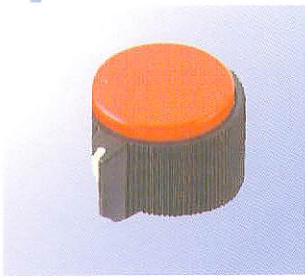

	A	B	C	D	SHAFT HOLE	
D	29.1	∅22.0	16.4	∅25.4	∅6.4	∅6.1
E	23.0	∅13.2	16.2	∅19.5	∅6.4	∅3.2
F	15.0	∅8.9	15.1	∅13.2	∅6.4	∅6.1 ∅3.2

FEATURES:

- Material : Phenolic.
- With white indicator line.
- Set screw on one side.
- With brass insert.



RN-120

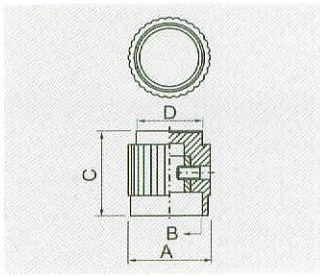

	A	B	C	D	SHAFT HOLE
	∅18.0	∅14.4	18.8	∅17.0	∅6.4

FEATURES:

- Material : Phenolic.
- With white indicator line.
- Set screw on one side.
- With brass insert.

RN-120L

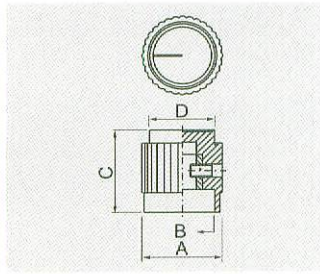

	A	B	C	D	SHAFT HOLE
	∅18.0	∅14.4	18.8	∅17.0	∅6.4

FEATURES:

- Material : Phenolic.
- With black indicator line.
- Set screw on one side.
- With brass insert.
- With aluminum spun inlay, inlay with indicator line.

RN-201

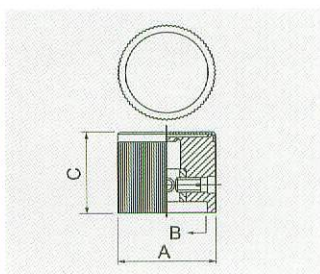

	A	B	C	SHAFT HOLE	
D	∅23.4	∅19.5	19.4	∅6.4	
E	∅18.2	∅15.1	14.7	∅6.4	∅3.2
F	∅13.5	∅10.3	12.1	∅6.4	∅3.2

FEATURES:

- Material : Phenolic.
- Set screw on one side.
- With brass insert.
- With aluminum spun inlay.



RN-203

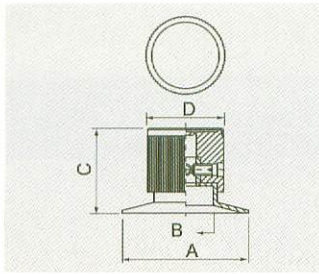

	A	B	C	D	SHAFT HOLE	
D	∅39.0	∅16.7	26.0	∅23.4	∅6.4	
E	∅29.3	∅11.9	19.1	∅18.0	∅6.4	∅3.2
F	∅22.9	∅7.9	17.8	∅13.4	∅6.4	∅3.2

FEATURES:

- Material : Phenolic.
- With white indicator line.
- Set screw on one side.
- With brass insert.
- With aluminum spun inlay.



RN-204

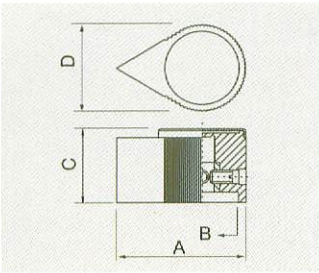
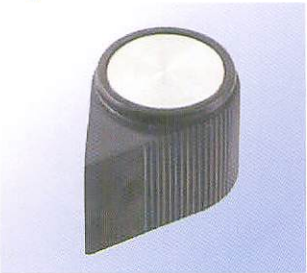

	A	B	C	D	SHAFT HOLE	
D	34.3	19.3	19.5	∅23.3	∅6.4	
E	26.5	14.8	14.7	∅18.0	∅6.4	∅3.2
F	19.4	10.4	12.3	∅13.4	∅6.4	∅3.2

FEATURES:

- Material : Phenolic.
- Set screw on one side.
- With brass insert.
- With aluminum spun inlay.



RN-206

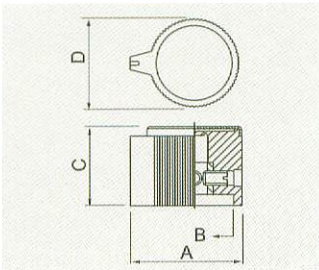

	A	B	C	D	SHAFT HOLE	
D	26.7	∅19.3	19.3	∅23.4	∅6.4	
E	20.7	∅14.7	14.7	∅18.0	∅6.4	∅3.2
F	15.6	∅10.3	12.2	∅13.4	∅6.4	∅3.2

FEATURES:

- Material : Phenolic.
- With white indicator line.
- Set screw on one side.
- With brass insert.
- With aluminum spun inlay.



REFERENCE TABLE

Knobs

POINTER KNOBS

NO.	ITEM NO.	SHAFT HOLE(Ø)					Set screw	PAGE
		6.4mm	6.1mm	3.2mm	D hole	18 teeth		
1	PN-1	★					Side	1
2	PN-1B	★					Side	1
3	PN-8C	★	★				Side	1
4	PN-8D	★	★				Side	1
5	PN-8E	★	★				Side	1
6	PN-8F	★	★	★			Side	1
7	PN-8G			★			Side	1
8	PN-9C	★					Side	2
9	PN-9D	★	★				Side	2
10	PN-9E	★				★	Side	2
11	PN-9F	★		★		★	Side	2
12	PN-24	★			★		Side	2
13	PN-26A	★					Side	2
14	PN-26B	★	★				Side	2
15	PN-27	★					Side	3
16	PN-31B1	★					Side	3
17	PN-31B2				★		Side	3
18	PN-32	★			★		Side	3
19	PN-33A	★	★				Side	4
20	PN-33B	★	★				Side	4
21	PN-33C	★					Side	4
22	PN-35	★	★				Side	4
23	PN-36	★					Side	5
24	PN-37	★	★				Side	5

CONTROL KNOBS

NO.	ITEM NO.	SHAFT HOLE(Ø)						PAGE
		6.4mm	6.1mm	3.2mm	D hole	18 teeth	Set screw	
1	RN-71B	★					Side	6
2	RN-71C	★					Side	6
3	RN-92A	★					Side	6
4	RN-92B	★					Side	6
5	RN-99A	★					Side	6
6	RN-99C	★	★				Side	6
7	RN-99D	★	★				Side	6
8	RN-99E	★	★				Side	6
9	RN-99F	★	★	★			Side	6
10	RN-100B	★	★				Side	7
11	RN-100C	★					Side	7
12	RN-100D	★					Side	7
13	RN-100E	★					Side	7
14	RN-100F	★					Side	7
15	RN-110C	★					Top	7
16	RN-110D	★	★				Top	7
17	RN-110E	★	★				Top	7
18	RN-110F	★	★				Top	7
19	RN-110G		★		★		Top	7
20	RN-110CS	★					Side	7
21	RN-110DS	★					Side	7
22	RN-110ES	★					Side	7
23	RN-110FS	★					Side	7
24	RN-110GS				★		Side	7
25	RN-110CH	★					Top	7
26	RN-110DH	★	★				Top	7
27	RN-110EH	★	★				Top	7
28	RN-110FH	★	★				Top	7
29	RN-110GH		★		★		Top	7
30	RN-112A	★					Side	8
31	RN-112B	★					Side	8
32	RN-113A	★					Side	8
33	RN-113B	★					Side	8
34	RN-114A	★					Side	9
35	RN-114B	★					Side	9
36	RN-117A	★					Side	9
37	RN-117B	★					Side	9
38	RN-118D	★					Side	10
39	RN-118E	★	★		★		Side	10
40	RN-118F	★			★		Side	10
41	RN-120	★	★				Side	10
42	RN-120L	★					Side	10
43	RN-201D	★					Side	10
44	RN-201E	★			★		Side	10
45	RN-201F	★			★		Side	10
46	RN-203D	★					Side	11
47	RN-203E	★			★		Side	11
48	RN-203F	★			★		Side	11
49	RN-204D	★					Side	11
50	RN-204E	★			★		Side	11
51	RN-204F	★			★		Side	11
52	RN-206D	★					Side	11
53	RN-206E	★			★		Side	11
54	RN-206F	★			★		Side	11